

SPECIFICATION FOR APPROVAL

REF :

PAGE: 1

PROD. NAME	RADIAL INDUCTOR	ABC'S DWG NO. ABC'S ITEM NO.	RB1314□□□□L□-□□□
---------------	-----------------	---------------------------------	------------------

. CONFIGURATION & DIMENSIONS :

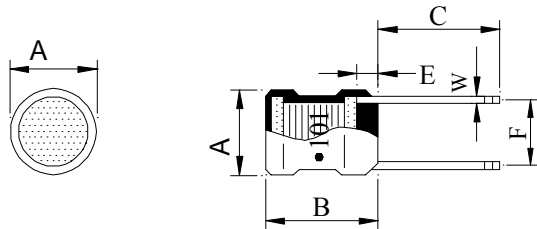

A	: 11.7±0.8	m/m
B	: 12.0±1.0	m/m
C	: 15.0±3	m/m
D	: 18.0±3	m/m
E	: 2.5 ⁺⁰	m/m
F	: 9.0±1.0 (A) 7.0±0.8 (B)	m/m
W	: Per spec. (A) 0.80 (B)	m/m

Marking :

" ● " : Start

Fig : A (3.3μH~47μH)

● 101----100 uH (Inductance code)

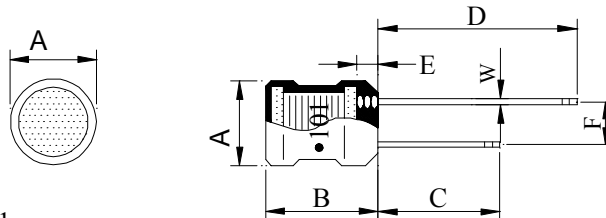

Marking : 101

" ● " : Start

Fig : B (68μH~15mH)

. SCHEMATIC DIAGRAM :



. MATERIALS :

- a . Core : Ferrite DR core
- b . Wire : Enamelled copper wire (Class F)
- c . Lead : Sn/Ag/Cu
- d . Tube : Sheinkable tube 125 , 600V
- e . Remark : Products comply with RoHS' requirements

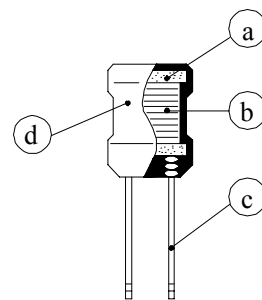

. GENERAL SPECIFICATION :

- a . Temp. rise : 20 max. at reted current.
- b . Storage temp. : -40 ---- +105
- c . Operating temp. : -25 ---- +85

AR-001A

SPECIFICATION FOR APPROVAL

REF :

PAGE: 2

PROD.	RADIAL INDUCTOR	ABC'S DWG NO.	RB1314□□□□L□-□□□
NAME		ABC'S ITEM NO.	

. ELECTRICAL CHARACTERISTICS :

DWG No.	Inductance (μ H)	Q ref.	Test Freq. (Hz)		SRF (MHz) typ.	RDC (Ω) max.	IDC (A) max.	W m/m
			L	Q				
RB13143R3ML□-□□□	3.3 \pm 20%	90	1K	7.96M	59.00	0.008	5.600	0.8
RB13144R7ML□-□□□	4.7 \pm 20%	100	1K	7.96M	45.00	0.009	4.700	
RB13146R8ML□-□□□	6.8 \pm 20%	80	1K	7.96M	34.00	0.012	3.900	0.7
RB1314100ML□-□□□	10.0 \pm 20%	140	1K	2.52M	26.00	0.015	3.200	
RB1314150ML□-□□□	15.0 \pm 20%	120	1K	2.52M	19.00	0.019	2.600	
RB1314220KL□-□□□	22.0 \pm 10%	110	1K	2.52M	14.00	0.026	2.200	
RB1314330KL□-□□□	33.0 \pm 10%	100	1K	2.52M	10.00	0.045	1.800	0.6
RB1314470KL□-□□□	47.0 \pm 10%	90	1K	2.52M	8.30	0.056	1.500	
RB1314680KL□-□□□	68.0 \pm 10%	80	1K	2.52M	6.70	0.092	1.200	0.8
RB1314101KL□-□□□	100.0 \pm 10%	70	1K	796K	5.40	0.120	1.000	
RB1314151KL□-□□□	150.0 \pm 10%	70	1K	796K	4.30	0.200	0.820	
RB1314221KL□-□□□	220.0 \pm 10%	40	1K	796K	3.40	0.250	0.680	
RB1314331KL□-□□□	330.0 \pm 10%	40	1K	796K	2.70	0.420	0.550	
RB1314471KL□-□□□	470.0 \pm 10%	30	1K	796K	2.30	0.510	0.460	
RB1314681KL□-□□□	680.0 \pm 10%	30	1K	796K	1.90	0.790	0.380	
RB1314102KL□-□□□	1000.0 \pm 10%	40	1K	252K	1.60	1.300	0.310	
RB1314152KL□-□□□	1500.0 \pm 10%	30	1K	252K	1.30	1.700	0.250	
RB1314222KL□-□□□	2200.0 \pm 10%	60	1K	252K	1.10	2.900	0.210	
RB1314332KL□-□□□	3300.0 \pm 10%	50	1K	252K	0.90	3.700	0.170	
RB1314472KL□-□□□	4700.0 \pm 10%	50	1K	252K	0.76	5.600	0.140	
RB1314682KL□-□□□	6800.0 \pm 10%	60	1K	252K	0.65	9.400	0.120	
RB1314103KL□-□□□	10000.0 \pm 10%	80	1K	79.6K	0.53	12.000	0.100	
RB1314153KL□-□□□	15000.0 \pm 10%	70	1K	79.6K	0.41	15.000	0.082	

- 1). □ : Packaging information... [A]: Bulk [B]: Trey
- 2). "-□□□": Reference code
- 3). Lead : 0.6 0.8 m/m soldered copper wire (3.3uH 47uH)
 Lead : 0.8 m/m tinned copper wire (68uH 15mH)

AR-001A



SPECIFICATION FOR APPROVAL

REF :

PAGE: 3

PROD. NAME	RADIAL INDUCTOR	ABC'S DWG NO.	RB1314□□□□L□-□□□
		ABC'S ITEM NO.	

. DWGING NUMBER EXPRESSION :

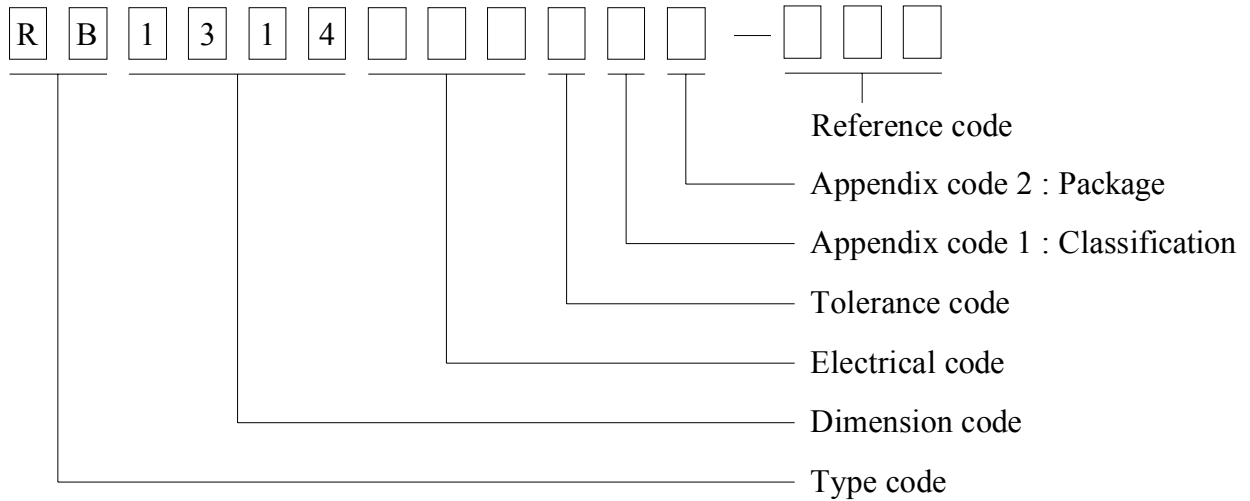

Appendix code 1 : Product Classification

L : Lead Free Standard products comply with RoHS' requirements

1 ~ 9 : Lead Free Special products comply with RoHS' requirements

Appendix code 2 : Package Information

Code	Inner package	Inner package Q'TY	Remark
A	Box	130 pcs	680K 153K
B	Tray	280 pcs	3R3M 470K(A type)
C	Box	150 pcs	3R3M 470K

AR-001A

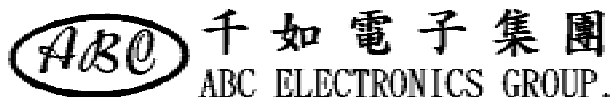

SPECIFICATION FOR APPROVAL

REF :

PAGE: 4

PROD. NAME	RADIAL INDUCTOR	ABC'S DWG NO.	RB1314□□□□L□-□□□
		ABC'S ITEM NO.	

UL CARD :

OBMW2 September 8, 2000
Magnet Wire-Component

JUNG SHING WIRE CO LTD E174837
231 CHUNG CHENG RD, SEC 3 JEN-TEH HSIANG, TAINAN
HSIEN TAIWAN

Mtl Dsg	Mark Dsg	BC	Coat Typ	OC	ANSI Type	Temp Class
AIW	---	Polyamideimide		---	MW81-C	220
CFUEWB	---	Polyurethane		---	MW75C	130
EIAIW	---	Polyesterimide		Polyamideimide	MW35C	200
EILOCKY	---	Polyesterimide		Polyamide	---	180
EILOCKW	---	Polyesterimide		Modified Epoxy	---	200
EIW	---	Polyesterimide		---	---	220
EIW-2	---	Polyesterimide		---	MW74-C	200
FL.EILOCKY	---	Modified Polyester		Polyamide	---	155
LSFFW	---	Polyurethane		---	MW79-C	155
LSUEW	---	Polyurethane		---	---	130
PEW	---	Polyester		---	---	155
PEY	---	Polyester		Nylon	MW24-C	155
SF.FLW	---	Modified Polyester		---	MW26C	155
SF.EIW	---	Polyesterimide		---	MW77C	180
SF.BY@	---	Modified Polyester		Nylon	MW27-C	155
SF.FLY@	---	Modified Polyester		Nylon	MW27-C	155
SF.BLOCKBS	---	Modified Polyester		Modified Polyamide	---	155
SF.EILOCKY#	---	Polyesterimide		Polyamide	---	180
SF.EILOCKBS	---	Polyesterimide		Modified Polyamide	---	180
SF.BW@	---	Modified Polyester		---	MW26C	155
SFFW	---	Polyurethane		---	MW79	155

287806002 Page 1 of 2

A not-for-profit organization dedicated to public safety and committed to quality service

Mtl Dsg	Mark Dsg	BC	Coat Typ	OC	ANSI Type	Temp Class
SFFY	---	Polyurethane		Polyamide	MW80C	155
UEW-1	---	Polyurethane		---	MW2-C	105
UEW-2	---	Polyurethane		---	---	130
UEW-4	---	Polyurethane		---	MW75C	130
UEY	---	Polyurethane		Nylon	MW28-C	130
UEY-2	---	Polyurethane		Polyamide	MW28-C	130

@-May be suffixed by LZ; # - May be suffixed by LZ, EL or LZI.
LZ - Signifies magened wires twisted together, EL - signifies base coated magnet wire laid parallel with top coat applied overall; LZL - signifies base coated magnet wire twisted together and covered with top coat overall.

Marking: Company name or trademarks or 榮星電線, material designation or marked designation on packaed or reel, and Recognized Component Mark.

See General Information Preceding These Recognitions
For use only in equipment where the acceptability of the combination is determined by Underwriters Laboratories Inc.

287806002 Page 2 of 2

OBMW2E174837
September 8, 2000

AR-001A

